

# PENDLE HERITAGE NEWS

SPRING 2007

50p



1|2 1 Higherford Mill from Pendle Water, 2 Blocked up 17th c. doorway discovered during the restoration of Park Hill,  
3|4 3 The new display at Park Hill, 4 Heritage Open Days 2006 at Higherford Mill.

Heritage Lottery Fund support for two Pendle Museums

- A new Trust - The North West Traditional Building Trust
- The W J Smith Archive
- Up-date on Higherford Mill
- Traditional Building Craft Skills
- Friends of Pendle Heritage
- Heritage Open Days 2007
- The Whitefield Conservation Shop
- A New Appointment

# Memorable occasion at Pendle Heritage Centre

Dr. Ron Brunskill, President of the Ancient Monuments Society and author, very kindly agreed to come to the Centre on 30 August 2006 to speak to our invited audience gathered for the launch of a new Trust - the North West Traditional Buildings Trust, and with his permission, we are delighted to include his speech of welcome.

"We are gathered together this evening to celebrate three achievements of the Heritage Trust for the North West : the new exhibition at the Pendle Heritage Centre, the creation of a North West Traditional Buildings Trust, and the short-listing of Higherford Mill in the BBC TV 'Restoration Village' Series.

As it happens, this week is the 100th anniversary of the birth of one of the foremost saviours of historic buildings in our lifetime : the late Sir John Betjeman, Poet Laureate, TV Celebrity and Architectural Historian. It is not necessary to be a poet to be an enthusiast for historic buildings, though it helps; it is not necessary to have such an active social life as Betjeman, though that seems to have been no handicap; it is not essential, but it seems to have been desirable, to maintain a wide range of interests, though this was characteristic of Sir John. The achievements we celebrate this evening illustrate the wide range of interests epitomised by the Heritage Trust for the North West under the energetic leadership of its Director, John Miller.

First let me say a few words about the new exhibition. This was made possible by the recent campaign for the conservation of Park Hill which revealed countless items of interest. Part of the exhibition, then, is the story told by the building itself. But the building is not simply a collection of stones, it is a living entity housing families and domestic activities over the ages. The building is also of historic significance in East Lancashire and so exhibition galleries have been formed, in such a way as to enhance the rooms which add to the developing history of Park Hill and its setting. May I therefore, formally declare open the Exhibition at Pendle Heritage Centre.

Secondly may I introduce a new development in the work of the Heritage Trust for the North West. Much of the success of Sir John Betjeman's conservation work derived from his outgoing personality whereby he communicated not only his enthusiasm for historic buildings but also the details of their planning, construction and decoration, as discovered by scholars including himself. Over a period of more than half a century we have cherished in our company a scholar in the person of W J Smith. John Smith, backed by his wife Kit (an artist and illustrator in her own right) has devoted much of his life to the study of traditional buildings of the North West. But he has not been content with the study, the amassing of information. He has interpreted the material and he has communicated the results not only in reports and publications but also in lectures and classes with a dedication that only those who remember trudging from Manchester to Clitheroe in winter by train and bus carrying a heavy mahogany box with glass slides can fully appreciate. So over the years, John Smith, an expert photographer and draughtsman, has built up a great collection of material about traditional buildings and how they were used. He is anxious that this should be available to future generations of enthusiasts and students and has offered the material to the care of the Heritage Trust for the North West. The gift has been accepted and a separate body has been set up: the **North West Traditional Buildings Trust**, which with grant aid, will care for the material and make it available for study, example, and educational and exhibition uses. Furthermore it is hoped that other scholars will follow the example of John and Kit Smith to add their collections to expand this priceless archive. Already some half dozen have expressed an interest. So

from this beginning we can foresee a vigorous study and educational centre to add further depth to the conservation achievements of the Heritage Trust for the North West.

Finally let me refer to Higherford Mill and the BBC. Many of you will know the mill as having such an important part to play in the history and townscape of Barrowford and will know of the five-year campaign to prevent its demolition. Much work on the repair of the building and its conversion to new uses has already been done. However, much remains outstanding and we must all hope for success against stiff competition in the BBC TV 'Restoration Village' Series.

At Pendle Heritage Centre we are able to experience the totality of what makes up the salvation of our built heritage : fine buildings, deep research, wide education and publicity and enthusiastic public participation. The Park Hill, restoration, the new exhibition, the W J Smith donation, the bright prospects for the Traditional Buildings Trust and the possibility of success in the nationwide competition will hopefully make 2006 another landmark year in the Betjemanesque poetry of our heritage."

**R W Brunskill**

We would like to thank Dr. Brunskill for launching the new Trust, receiving the W J Smith Collection, and opening the new museum exhibition in the Centre.





**W. John and Kit Smith** have been strong supporters of the Trust and members of the Friends from the outset. John researched and produced the architectural and historical appraisal of Park Hill in 1983, which was to prove very important for the proposals for the restoration and development of the Centre.

W. John Smith is an architectural historian and buildings archaeologist. He is an acknowledged authority on the architecture of the North West, tutoring W.E.A. and extra-mural courses for over thirty five years. Kit Smith is a painter and illustrator of architectural subjects. Together they have produced and illustrated 'The Architectural History of Towneley Hall, Burnley', one of the Historic Houses in Lancashire series published by Heritage Trust for the North West.

## Aims of the North West Traditional Buildings Trust

The establishment of a specialist centre for the study of traditionally-constructed buildings in the North West of England, covering the area of operation of the Heritage Trust for the North West.

- To serve as a repository for existing collections of reports, photographs, slides and drawings that at present are inaccessible to researchers or are in danger of being lost or dispersed.
- To support the educational and conservation work of the Heritage Trust for the North West by providing detailed information about traditional buildings, building materials and construction techniques and assist it in the promotion of appropriate repair and maintenance techniques.
- To make its resources widely available to building owners, building professionals, historians, schools, universities and anyone with an interest in buildings.
- To use digital scanning, database and internet technologies to make its collections easily searchable and accessible.
- To promote debate and communication between building researchers and to develop research frameworks that will enable future recording work to be directed in the most useful ways.
- To assist building owners and their advisors by providing a secure repository for 'log books' or similar documents recording information that may be of future practical use, including records of repairs and alteration works.
- To provide information about past uses, performance and sources of local natural materials in order to encourage more sustainable construction.

The North West Traditional Buildings Trust has six Trustees:

**Dr Andrew White**, formerly Head of Museums at Lancaster City Council and writer on historic buildings. Chairman.

**Dr Ronald Brunskill**, formerly of the University of Manchester and pioneer of the study of Vernacular Architecture.

**Jonathan Ratter**, a Surveyor in private practice in Morecambe, with an unrivalled understanding of the practical issues involved in the care of historic buildings.

**W J Smith and Kit Smith**, the creators of the Collection to be held in Trust.

**Philip Powell**, formerly Conservation Officer for Wigan Metropolitan Borough Council.

# The Heritage Centre at Park Hill



Formal opening of Park Hill, 20 October 1977

2007 is the thirtieth anniversary of the formal opening of Park Hill on 20 October 1977, by Asa Briggs (now Lord Briggs), then Chairman of the Heritage Education Group, based in London. At the time the Centre was one of only four Heritage Centres in the United Kingdom, the others being in York, Chester and Faversham in Kent.

In 1983 Sir Roger and Lady Bannister formally opened the Bannister Room and the first interpretative displays on Park Hill, followed by the large 'Story of Pendle' Exhibition funded by the Carnegie Trust. This popular display stayed until the late 1990s when the Trust was awarded a generous Heritage Lottery Fund grant to produce new exhibitions and a further restoration of the house. This involved the removal of inappropriate partitions and unsuitable materials such as modern plaster which were damaging the fabric of the building. Further archaeology and carbon testing of the old timbers revealed much about how the house had developed. Unsightly modern timber frames in the stone mullion windows were replaced with leaded lights with small square or diamond panes of the 16th and 17th centuries. Inter-active programmes now enable the visitor to 're-assemble' the house and understand how the building grew and developed over successive centuries. Traditional lime plaster was used allowing the walls to breathe. Steel ramps and a modern platform lift now provide access to the first floor. The exhibition tells the story of Park Hill through its vernacular architecture which reflected the aspirations of its owners and the fashions of each period through often turbulent times of religious upheaval, civil war, witchcraft and superstition.

The main exhibitions are in the older part of the house which still evokes the atmosphere of the 17th century and include:

- The story of a Lancashire farmhouse. Dating from the 15th century, Park Hill was a working farm for most of its existence.
- The history of the Bannister family who settled at Park Hill in the 1400s and of the Swinglehursts who occupied part of the house from the late 18th century and who built the Georgian extension and walled garden.
- The story of the notorious Pendle Witches which resulted in their famous trial in 1612, together with a film dramatization.
- A small Garden Museum housed in the old potting and cart sheds at the end of the 18th century walled garden. A video produced by Peter and Daphne Copestake records the garden through the seasons and there is a display of early garden implements.

## Comments from Visitors to the Heritage Centre

'Very impressive. Excellent Museum (and I've seen my share around the World)'. *S. Australia*

'An excellent history lesson, I especially enjoyed the introduction and commentary at the beginning about the building'. *Cyprus*

'Very interesting reading. Well pleased with visit'. *Mossley*

'So scholarly, yet accessible'. *Cheshire*

'What a lovely place to stop and look around on our journey'. *Manchester*

'Too much to take in one visit, we shall return'. *Derby*

'Third visit - always good'. *Nelson*

'Gets better on every visit'. *Barnoldswick*

'So impressed on our visit a month ago, just had to bring our American cousin'. *Leeds*

'Never been in before! Extremely interesting'. *Barrowford*

'Well worth £2! Will come again'. *Southport*

PARK HILL, Barrowford.

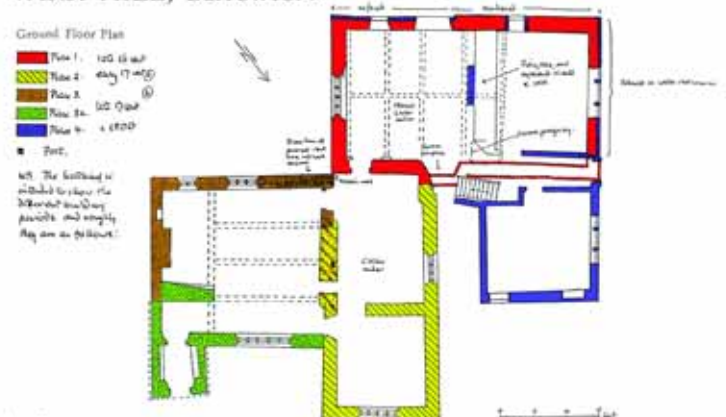

© WJ Smith, 1983

The first architectural survey of Park Hill by WJ Smith, 1983



The front of Park Hill, showing the stages of construction

# New Appointment

## Operations Manager at Pendle Heritage Centre

The Heritage Centre over thirty years, has grown into the premier visitor attraction in Pendle, with over 100,000 visitors a year and it has long been apparent that it was important to appoint an Operations Manager to co-ordinate the project and to carry it forward without distraction. The increase in grant from Pendle Borough Council has helped to pay for the post.

Angela White was appointed in July 2006 and started work in August, initially helping with the huge workload and activity generated by the BBC Restoration Village programme on the Mill.

Coming from a cross channel ferry background where she was a purser, she is admirably suited to deal with the general public, health and safety, emergencies and the management of a busy complex site, open seven days a week, throughout the year. One of her important tasks is to boost the occupancy of the Park Hill Barn and to increase visitor numbers at the less busy times of the week and day.

## The Yorkshire Dales Mining Museum, once the Earby Mining Museum, has received a generous grant from the Heritage Lottery Fund.



The Museum occupies one of the oldest and interesting buildings in Earby. Once the Old Grammar School, or Robert Windle's Free School, founded in 1594, the building still functioned as a school as late as 1910, after which it found several uses up until 1970 when it became empty. Then the Robert Windle Foundation Trustees offered the building, at a peppercorn rent, as a Museum to 'Earby Mines Research Group'. Lead miners from the Yorkshire Dales came to the Earby area as the Dales mines were closing, to work in the coal and textile industries.

In 2006, the Museum re-opened after almost four years of renovation and refurbishment, funded by English Heritage, the Heritage Lottery Fund, Pendle Borough Council, ably supplemented by Museum Friends and local charities and groups.

The building now has displays on both floors, a lift and disabled facilities, and a tea-room. Fascinating new interpretative displays of original artefacts, tools, mining wagons and photographs, are on view, and outside is the dramatic Kettlewell Providence Mine waterwheel and ore crusher, rescued from the scrap in September 1971.



Formal opening of the Bannister Room by Sir Roger and Lady Bannister, 1983



Sir Roger Bannister welcomes HRH The Prince of Wales to Park Hill on 24 October 2003

### The Bannister Family and The Walled Garden

Two new booklets, one the 18th c. Walled Garden at Park Hill and another on the Bannister family who built the house, have just been published by the Trust. On sale in the Centre (or by mail order, tel. 01282 661702) priced at £3.00 (£3.65 with post and packaging)

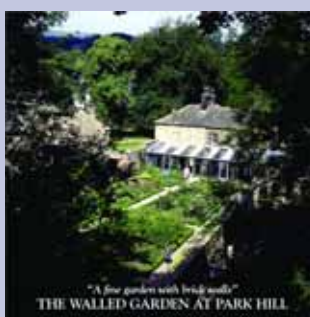

The Yorkshire Dales Mining Museum is open from 24 March until the end of October 2007 on Wednesdays, Saturdays, Sundays, and Bank Holiday Mondays, 11am - 5pm. (Adult £2.50, Senior Citizens £2.00, Children £1.00, Family Ticket £6.00). Groups of more than ten welcome at other hours by arrangement. Contact Mike Squirrel tel: 01943 601712.

# Higherford Mill - An Up-date

Rejected and almost demolished, Higherford Mill is, once again, back as the 'cornerstone' of the village of Higherford. We did not win the BBC TV Restoration Series in 2006 but, as one of only three buildings featured from the North of England, the Mill got invaluable national attention. The series also awakened the local community which rallied round with support and enthusiasm. People appeared who had worked in the mill, which, surprisingly, was still weaving as late as 1971. It was very important to promote the Mill before the programme went out on the evening of Friday, 8 September. Banners were erected on the Mill and elsewhere, and leaflets, posters and a newsletter were distributed far and wide by a team of volunteers. On the week prior to the broadcast vintage buses re-created the 'wakes' weeks of pre-war days and conveyed people carrying the message 'vote for Higherford Mill' to Heysham, Burnley, Lytham and 'over the border' to Heptonstall, Halifax, Settle and Skipton. The buses paused in busy squares, to be met by local Mayors and dignitaries to whom we are very grateful, particularly the Mayor and Mayoress of Pendle and the Chairman of Barrowford Parish Council who joined the tours.

## A special Open Evening and weekend attracted over 2,500 visitors to the Mill where exhibitions and tours brought the building to life.

Sadly, many felt that the programme did not do the building or the development proposals justice. Nothing was made of the 'green' dimension and one of the main features of a water powered mill, the sluices guiding water into the building to power the mill, was misrepresented as a problem of dilapidation.

One very positive outcome of the programme was a donation from Mrs Annette Whetton, from Somerset, daughter of TH Wiseman who owned the Mill in its heyday. Mrs Whetton has donated £10,000, which will help with the formation of a new Reception area on the ground floor. With Gift-Aid, the Trust is able to claim a further £2,800 from the Inland Revenue, making the donation £12,800.

The first two phases of the restoration are almost complete, and the principal sections of the building now structurally secure. The imposing three storey central section has been completely re-roofed, its windows

renewed, rewired and emergency services installed. The original lift has been totally refurbished. New lavatories (with disabled facilities on ground and second floors) are in place.

12 studios, from the first phase of work, are occupied by practising artists, and a further 24 studios will be completed in phase 2. There is a waiting list of artists wishing to occupy them.

Work is proceeding on the new reception area proposed for the ground floor loading bay. The concrete floor has been excavated to reveal much of the original stone surface of flags and setts, including the configuration of the entrance flags on which the wagon wheels ran.

We would like to thank Cllr. John David for his enthusiastic support during the campaign, and to Pendle Borough Council for financial support.

## A new home for the Trust

For some time it was evident that Heritage Trust for the North West needed a new base for its expanding range of activities and the facilities at the Pendle Heritage Centre had become too constricting. To many the Trust was identified only with the Centre and this was sometimes confusing.

It was therefore thought appropriate to relocate the Trust's Administrative and Finance staff to the second floor of Higherford Mill, where there is also room for expansion.

The first members of staff moved in on the 4th December and Trustees of Heritage Trust for the North West held a meeting in the new Boardroom on 6th December 2006.



Vintage Bus on a tour of Heptonstall and Halifax, Photograph courtesy of Rob Oldland



Tour of Higherford Mill, Photograph courtesy of Roger Dyson

# Traditional Building Craft Skills

Our knowledge and experience of repairing and conserving early buildings has progressed a great deal in the last 10 years but we will have a long way to go in training a new generation of craftsmen in traditional methods. This is not just from 'purist motives' but because early buildings were and still are being actively damaged by the mistaken use of modern materials and techniques. People often pay only 'lip-service' to guidelines and important details and original fabric can be irreparably lost.

Heritage Trust for the North for the North West is one of 200 Building Preservation Trusts in the UK and has now built up its own core staff, skilled in traditional methods, forming its own wholly owned subsidiary company 'Conservation Services NW' which specialises in traditional building craft skills. It employs a Building Manager, and ten builders, joiners and labourers. Their specialist skills include:

- laying cobbles and setts, and stone paving
- dry stone walling

- re-laying stone and blue slate roofs
- construction of sash windows, and traditional panel doors
- using traditional lime mortars, limewash and lime plaster
- using natural paints and finishes



*Lime plaster being applied to the wall at Pendle Heritage Centre. Three layers were required before the final yellow limewash was applied.*



*Re-cobbling the farmyard at Park Hill*

The Trust has obtained Planning Permission to establish a permanent Centre for Traditional Building Craft Skills in Whitefield Weaving Sheds where others can be trained. We have established contacts with suppliers of traditional materials, and it is gratifying to see more and more of these available through normal trade outlets.

We also intend to extend the new exhibition within the Museum at Pendle Heritage Centre with more interactives on building techniques.



*The cobbled farmyard before restoration*



*The cobbled farmyard after restoration*

## The Whitefield Conservation Shop

**2 Victoria Street, Nelson, was purchased by the Trust in December 2001.** Originally a 'corner' shop at the end of a long row of terrace houses, the building had long since lost its original windows and doors, but still retained the early 'Victoria Street' stone street plaque until this was treated or rather 'mistreated' with sandstone cleaning by the first contractors. The first restoration was carried out in a very shoddy manner and against all the guidelines of conservation laid down by English Heritage. Much of the work, including the re-roofing is now being re-done by Heritage Trust for the North West's own builders using traditional materials and techniques.

When completed, 2 Victoria Street will become the 'Whitefield Conservation Shop' fitted out by the Whitefield Conservation Action Group with an 'Awards for All' grant of £9,000. The shop will be an Information and Exhibition Centre about the Whitefield Conservation Area and 'good and bad practice' in restoration. From the start, the Trust has committed itself fully in Lomeshaye and Whitefield not only in terms of money but even more so in time and energy.

This project (which has been given a Pride of Place Award by the David Knightley Charitable Trust) and the work of the Trust in Nelson will feature in the next newsletter in the Autumn.



*2 Victoria Street, Nelson*



*Visit by English Heritage Commissioners to Whitefield Weaving Sheds, Nelson, May 2006. The Sheds were acquired by the Trust in 2000.*

# Friends of Pendle Heritage News

## Annual General Meeting

The AGM will take place in the Park Hill Barn at the Heritage Centre on 16 May 2007 at 7.30pm. The meeting will be followed by a presentation of Film archives by Peter and Daphne Copestake.

## Pendle Heritage Archaeology Group

During the last few months the group has been carrying out the recording of the former waterwheel housing at Higherford Mill. Detailed drawings have been prepared of the waterwheel pit and mason's marks and other elements of the fine stonework to this area recorded. In addition a record has been made of the associated features within the housing.

It is proposed that field walking of the vaccaries within the Forest of Trawden and Pendle will commence shortly and that much more will be learnt about these during the summer months. Further details of this can be obtained from David Taylor, tel. no. 01282 773666.

The final lecture of the winter season will take place on 23rd March at 7.30 p.m. in the meeting room when Mrs Margaret Edwards of Preston will speak on "Stained Glass".

The group will be making a presentation of its recent work at the Council of British Archaeology, North West, Annual General Meeting at Lancaster on Saturday, 12th May.  
D. J. A. Taylor

## A message from the Chairman

Thank you for all the good wishes, flowers, support and encouragement during this period of "restricted activity"! My involvement with the Friends may be limited for a while but my enthusiasm for promoting Pendle Heritage remains intact.

If only I had listened more carefully... if only I had written it down... if only I could remember....my mother would have been one hundred years old on January 31st 2007 and whenever I reflect on aspects of her life I find unanswered questions and think of the missed opportunities I have had for finding the answers. I imagine that other people have experienced the same regrets.

A wonderful lady called Norah Lewis (nee Corcoran) recently celebrated her 100th birthday. Norah was born in Barrowford and lived on Sandy Lane for some years. She has lots of memories of when she was a young girl, family life, schooldays, local characters, learning to weave, etc. She recalls her memories with humour and we are privileged to have received a recording of some of her memories of life in Barrowford, Higherford and Nelson in years gone by. These personal memories are archives to treasure. My grateful thanks go to Norah, her relatives and to Frances Howarth, for taking the time and having the forethought to preserve such memories. Our congratulations and best wishes to Norah on achieving 100 years.

I know that Annual General Meetings are never the most popular events, but the Committee and I would feel so encouraged if you could be persuaded to come along. I appreciate that many of the Friends live too far away to actively participate in events or meetings, but we value your membership of the group.

I am delighted that Peter and Daphne Copestake have agreed to share 'some films from the archives' with us after the business of the evening. Our programme of events for the Autumn and Winter is already taking shape and I do hope you will be able to support us and perhaps persuade more friends to join us.

Spring is certainly in the air - I'm just hoping that there will be a 'spring in my step' before too long. **Anne Eves**

## Awards for All : Application for Funding

The Friends have been awarded a grant of £9,975 under the Heritage Lottery Fund 'Awards for All' towards the cost of researching and mounting an exhibition of photographs of historic buildings in Pendle, taken from the archives of Heritage Trust for the North West and the newly formed North West Traditional Buildings Trust. The new exhibition will be housed in the Green Room in the Centre and form part of the Museum Exhibition. The Friends still have to raise a further £5,000 before work can start. Any donations will be gratefully received.

## Heritage Open Days 2007 Sat 8 & Sun 9 September

The recently restored **2 Victoria Street** will be open as a Conservation Shop, and base for the Whitefield Action Group.

**Other buildings in Whitefield** owned by the Trust will be open to visitors.  
**Higherford Mill** - guided tours of the Mill and Artists Studios open.

